

SOLARIS ENCLOSURES QUOTE FORM



350 Burbank Road, Oldsmar, FL 34677
813-855-2627 FAX 813-855-8128

1-800-969-3706

Date _____ Customer #: _____
 Dealer Name _____
 Phone # _____ - _____ - _____ Fax # _____ - _____ - _____
 Requested By _____ Desired Ship Date _____ - _____
 P.O.# _____ Job Name (Cust. last name) _____
 Wind Speed or Snow Load Requirement _____

WALL INFORMATION

2" Non-Thermal **Kickplate Height**
 3" Non-Thermal 18"
 3" Thermal-Break 21" (standard)
Extrusion Color 24"
 White Adobe Other: _____
 Ivory Sandstone
 Bronze
Electrical Chase Holes in wall and extrusion (3" system only) YES
 If yes, _____ inches from base

WALL FINISH	WH	IV	BZ	AD	SD
.024 Aluminum Stucco					
.040 FRP Stucco					
.024 Aluminum Cedar					
.050 Luran					
.028 Rigiwall					

Indicate Interior (INT), Exterior (EXT), or BOTH in the appropriate row and column above. FRP is not available for EXT finish. Cedar finish must be 48" or under, to maintain vertical lines.

ROOF INFORMATION

Existing Roof? YES If Yes, check one: Angle Top Cap
Existing Roof type: Wood Panel Pan
If YES is marked for Existing Roof - Skip the rest of this section.

Roof Panels **Metal** **Finish** **Roof Trim** **Roof Color**
 1 lb. .024 Stucco Ext. Gutter & Val. White
 2 lb. .030 Cedar Ext. Fascia Trim Ivory
 _____" Roof Panel Foam Thickness Roof Projection: _____' _____"

Header _____ Roof Width: _____' _____"
 Thermo Fan Beams: _____
 Non-Thermo Skylights: _____

ROOF LAYOUT ONLY HOUSE

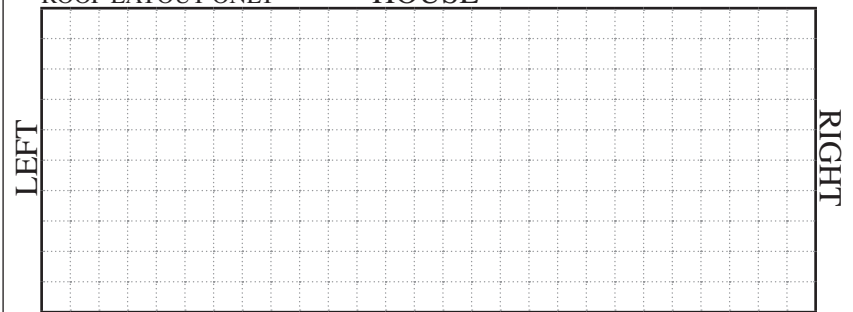

SHOW LOCATION ON ROOF LAYOUT FOR SKYLIGHTS AND FAN BEAMS

ROOM MEASUREMENTS

A. Room Projection L _____ R _____
 B. Room Width _____
 C. Side Wall Height L _____ R _____
 D. Front Wall Height _____
 E. Roof Projection _____
 F. Roof Width _____
 G. Roof Edge Height _____
 H. House Overhang _____

Please check one:
 To House Attachment (see diagram to right)
 To Soffit Attachment (see diagram to right)

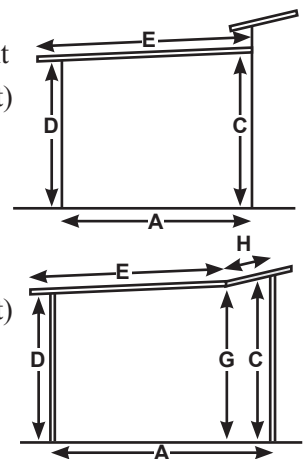

Please check one:
 Cut Pitch in Side Walls
 Do NOT Cut Pitch in Side Walls

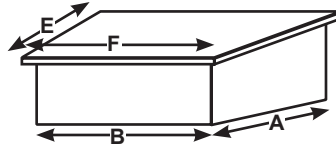

DOORS

2" Prime Entry Door (2" or 3" Wall)	Sliding Glass Door (3" Wall only)	Frame Color	Tint
<input type="checkbox"/> Full View	<input type="checkbox"/> Vinyl 4-Track	<input type="checkbox"/> White	<input type="checkbox"/> Clear
<input type="checkbox"/> Full View Ins.	<input type="checkbox"/> Left Hinge-In	<input type="checkbox"/> Bronze	<input type="checkbox"/> Grey
<input type="checkbox"/> Full Single Hung	<input type="checkbox"/> Left Hinge-Out	<input type="checkbox"/> Adobe	<input type="checkbox"/> Bronze
<input type="checkbox"/> Single Hung Ins.	<input type="checkbox"/> Right Hinge-In	<input type="checkbox"/> Sandstone*	<input type="checkbox"/> Other: _____
<input type="checkbox"/> Half Single Hung	<input type="checkbox"/> Right Hinge-Out		
	<input type="checkbox"/> 5'-0" x 6'-8"		
	<input type="checkbox"/> 6'-0" x 6'-8"	Options	
	<input type="checkbox"/> Single Glaze	<input type="checkbox"/> Key Lock	
	<input type="checkbox"/> Insulated	<input type="checkbox"/> Metal Handle	
	<input type="checkbox"/> Ins. Low-E	<input type="checkbox"/> Stnlss. S. Roller Pkg.	
		<input type="checkbox"/> Mortise lock w/handle	

ROOM TYPE

<input type="checkbox"/> SCREEN ROOM Screen Color: Charcoal Screen Mesh <input type="checkbox"/> 18/14 (Standard) <input type="checkbox"/> 20/20 (Up-charge) <input type="checkbox"/> Pet D-Fence (Up-charge)	<input type="checkbox"/> VINYL 4-TRACK Specs <input type="checkbox"/> Inside Mount <input type="checkbox"/> Outside Mount <input type="checkbox"/> Spring Load <input type="checkbox"/> PIN Screen <input type="checkbox"/> Window (OSM) <input type="checkbox"/> Wall Frame (ISM) Vinyl Color <input type="checkbox"/> Clear <input type="checkbox"/> Bronze <input type="checkbox"/> Grey <input type="checkbox"/> Purple Frame Color <input type="checkbox"/> White <input type="checkbox"/> Adobe <input type="checkbox"/> Bronze <input type="checkbox"/> Sandstone Spreader Bar <input type="checkbox"/> YES (under 40" wide)	<input type="checkbox"/> GLASS ROOM Window Type <input type="checkbox"/> Horizontal Slider <input type="checkbox"/> Single Hung <input type="checkbox"/> Deadlite <input type="checkbox"/> Transom (Top) <input type="checkbox"/> Glass Kickplate (Bottom) <input type="checkbox"/> Trapezoid <input type="checkbox"/> Other: _____ <hr/> Frame Color <input type="checkbox"/> White <input type="checkbox"/> Adobe <input type="checkbox"/> Bronze <input type="checkbox"/> Grey <input type="checkbox"/> Other _____ Glass Color <input type="checkbox"/> Clear <input type="checkbox"/> Bronze <input type="checkbox"/> Grey <input type="checkbox"/> Other _____ Glass Specs <input type="checkbox"/> Insulated <input type="checkbox"/> Tempered <input type="checkbox"/> Single Glaze <input type="checkbox"/> LOW-E <input type="checkbox"/> Other _____	<input type="checkbox"/> ACRYLIC ROOM Window Type <input type="checkbox"/> Horizontal Slider <input type="checkbox"/> Deadlite <input type="checkbox"/> Transom (Top) <input type="checkbox"/> Acrylic Kickplate (Bottom) <input type="checkbox"/> Trapezoid <input type="checkbox"/> Other: _____ Window Options <input type="checkbox"/> OSM (Outside Mount) w/ removable screen <input type="checkbox"/> OSM w/ spline groove (so you can roll in screen) <input type="checkbox"/> ISM (Inside Mount) Frame Color <input type="checkbox"/> White <input type="checkbox"/> Bronze Acrylic Color <input type="checkbox"/> 3/16" Clear <input type="checkbox"/> 3/16" Bronze <input type="checkbox"/> 3/16" Grey
---	---	--	---

WALL LAYOUT

Please indicate module sizes and location, room dimensions, door location and swing.
 Header panel will vary depending on unit height. Must be a minimum of 4".

