

Gulfport

3 Bedroom, 2-1/2 Bath,
1 Car Garage

OVERALL DIMENSIONS

26'-0" x 76'-0"

TOTAL LIVING AREA

2,181 sq.ft.

The raised floor and break-away lower walls make this home perfect for coastal areas.

The spacious kitchen has a peninsular counter top with built in bar, overlooking large dining and living room spaces.

Features include a large master suite, dedicated office, cozy fireplace and several outdoor areas to enjoy the fresh air.

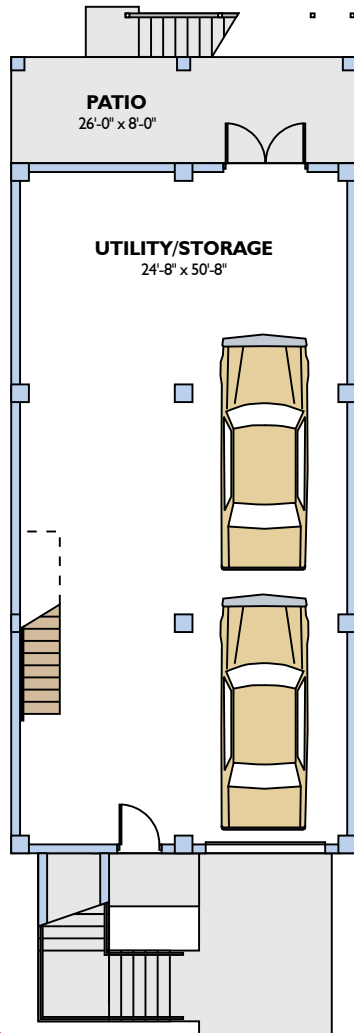

GROUND FLOOR PLAN

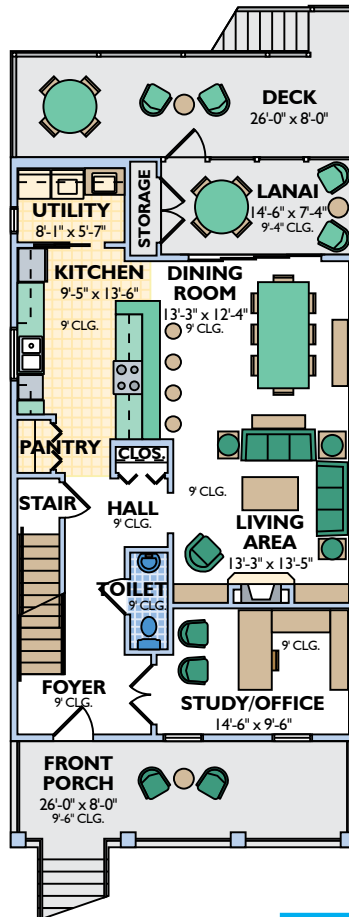

FIRST FLOOR PLAN

SECOND FLOOR PLAN

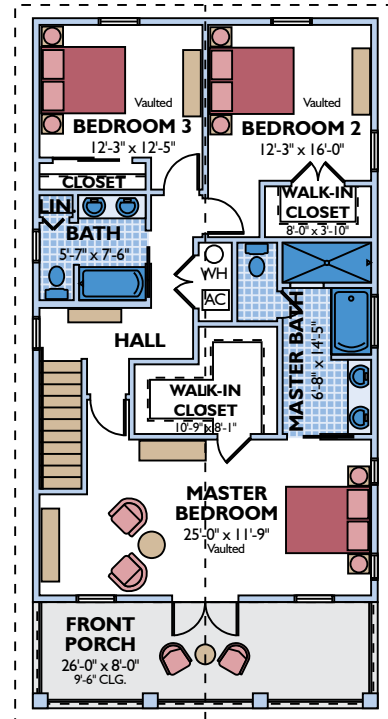

THE ORIGINAL
SNAP-N-LOCK
INSULATED PANEL

