

# Windham

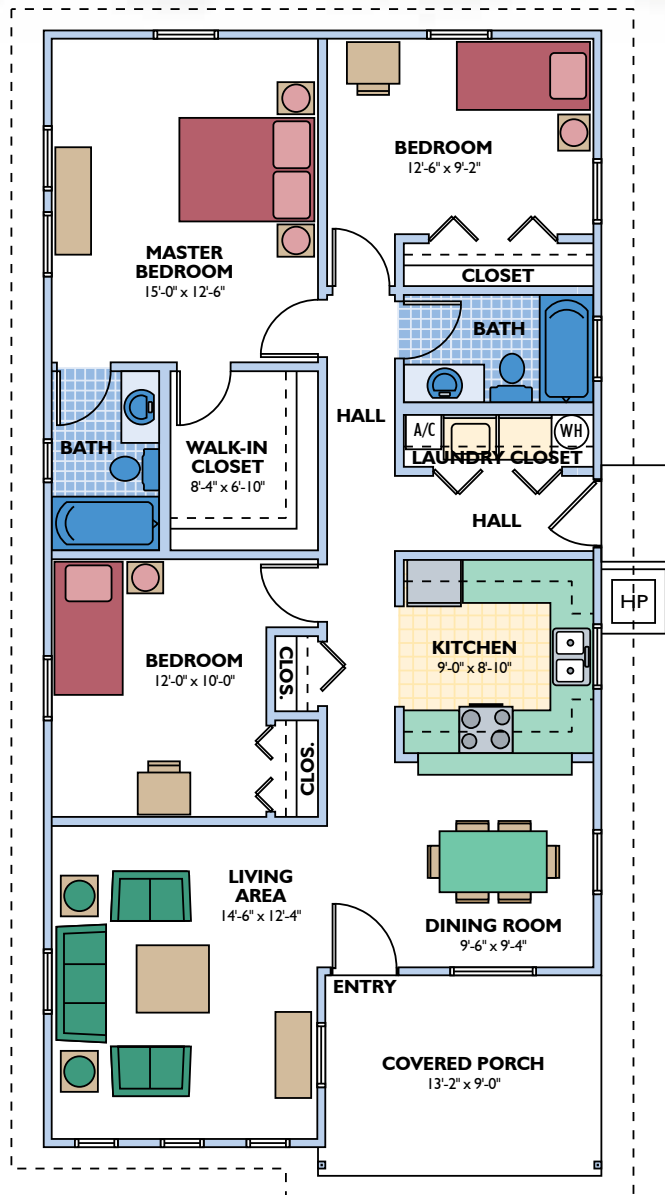
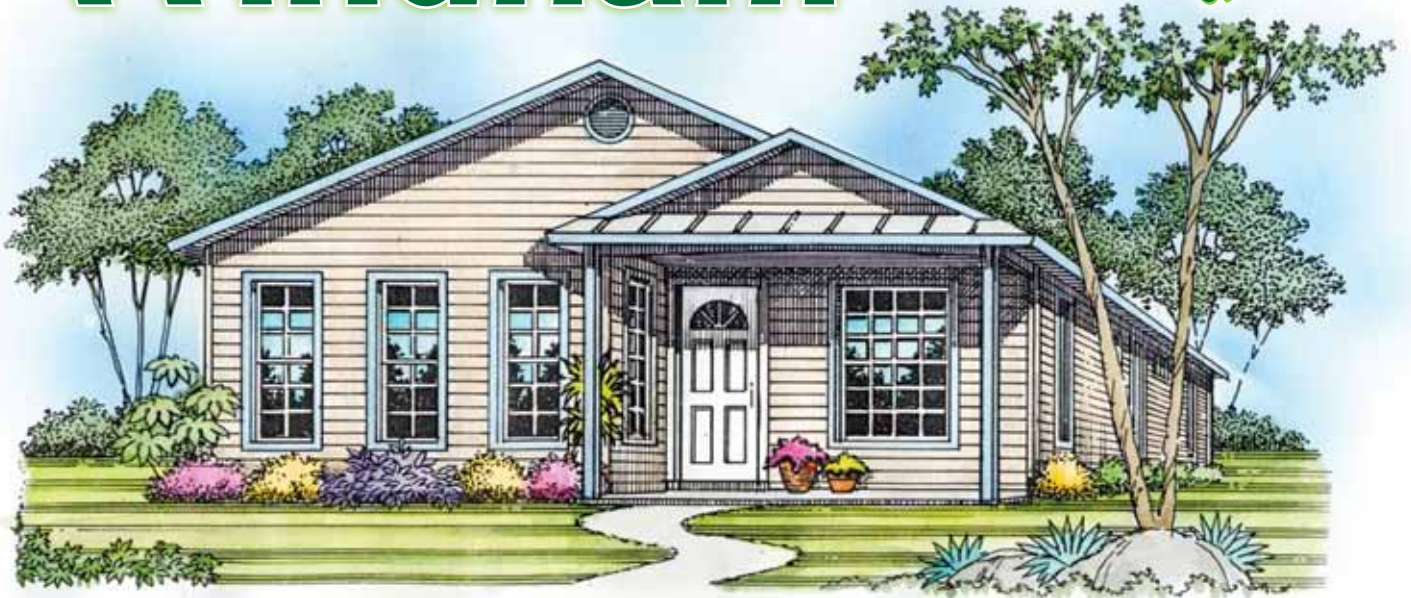

3 Bedroom, 2 Bath

**OVERALL DIMENSIONS**

26'-0" x 52'-0"

**TOTAL LIVING AREA**

1,249 sq.ft.

*The entryway is very inviting, with its attractive gable roof lines and large covered porch. As you enter, you'll notice that the living area is tucked off to your left every so slightly, offering some privacy. The pass-through to the dining area offers added convenience. Each room is a comfortable size to fit furnishings.*

